

Milling · Fräsen

Indexable Milling Tools · Wendepplattenfräser

High feed milling cutters · Hochvorschubschafffräser

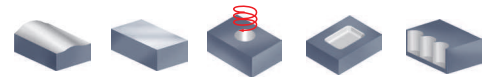

XMR01 P M K



W type insert, straight shank
W Typ WSP, Zylinder Schaft

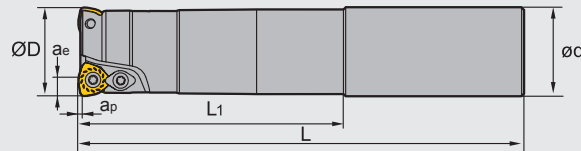





Specification of tools · Werkzeug Beschreibung

Type · Typ	Stock Lager	Dimensions (mm) · Abmessungen							No. of teeth Zähne	Weight Gewicht (kg)
		Ø D	a _p	a _e	L ₁	L	ø d			
XMR01 -020-G20-WP05-02-M	●	20	1.5	3.8	50	130	20	2	0.2	
-020-G20-WP05-02-L	●	20	1.5	3.8	100	180	20	2	0.3	
-020-G20-WP05-02-XL	○	20	1.5	3.8	130	250	20	2	0.8	
-025-G25-WP06-02-M	●	25	1.5	4.35	60	140	25	2	0.4	
-025-G25-WP06-02-L	●	25	1.5	4.35	120	200	25	2	0.6	
-025-G25-WP06-02-XL	○	25	1.5	4.35	180	300	25	2	1.0	
-032-G32-WP06-03-M	●	32	1.5	4.35	70	150	32	3	0.8	
-032-G32-WP06-03-L	●	32	1.5	4.35	120	200	32	3	1.0	
-032-G32-WP06-03-XL	○	32	1.5	4.35	180	300	32	3	1.6	
-040-G32-WP06-03-M	○	40	1.5	4.35	50	150	32	3	0.9	
-040-G32-WP06-03-L	○	40	1.5	4.35	50	250	32	3	1.5	
-040-G32-WP06-03-XL	○	40	1.5	4.35	50	300	32	3	1.8	
-040-G32-WP08-02-M	○	40	1.5	5.66	50	150	32	2	0.9	
-040-G32-WP08-02-L	○	40	1.5	5.66	50	250	32	2	1.5	
-040-G32-WP08-02-XL	○	40	1.5	5.66	50	300	32	2	1.9	
-050-G32-WP09-02-M	○	50	3.0	6.8	50	150	32	2	1.9	
-050-G32-WP09-02-L	○	50	3.0	6.8	50	250	32	2	2.5	

● Ex Stock / ab Lager ○ On demand / auf Anfrage

Spare parts · Ersatzteile

Tool Werkzeug	Clamp/Insert Screw Schraube	Clamp Pratze	Wrench Schlüssel	
				
XMR01**-WP05**	I60M3.5×08TT	—	WT10P	—
XMR01**-WP06**	I60M4×8.4	—	WT15P	—
XMR01**-WP08**	I60M5×13	WD-208	—	WT20IT
XMR01**-WP09**			—	

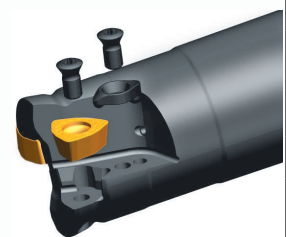

● Ex Stock / ab Lager ○ On demand / auf Anfrage

Milling · Fräsen

Indexable Milling Tools · Wendeplattenfräser

■ Applicable inserts · Wendschneidplatten

● Ideal Machining Condition / Gute Bearbeitungsbedingungen
 ● Normal Machining Condition / Normale Bearbeitungsbedingungen
 ● Unfavorable Machining Condition / Ungünstige Bearbeitungsbedingungen

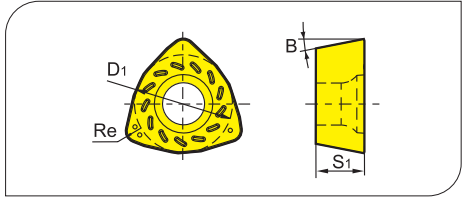

Workpiece Material / Werkstoffe	P	M	K	N	S	YBC301	YBC401	YBM251	YBM351	YBD152	YBD252	YBG102	YBG202	YBG205	YBG212	YBG152	YBG252	YNG151	YNG151C	YC30S	YD051	YD101	YD201
P Steel / Stahl	●	●	●	●	●	●	●	●	●	●	●	●	●	●	●	●	●	●	●	●	●	●	●
M Stainless Steel / Rostfreier Stahl	●	●	●	●	●	●	●	●	●	●	●	●	●	●	●	●	●	●	●	●	●	●	●
K Cast iron / Gusseisen	●	●	●	●	●	●	●	●	●	●	●	●	●	●	●	●	●	●	●	●	●	●	●
N Non-ferrite material / Ne Metalle	●	●	●	●	●	●	●	●	●	●	●	●	●	●	●	●	●	●	●	●	●	●	●
S Heat-resistant steel / Warmfester Stahl	●	●	●	●	●	●	●	●	●	●	●	●	●	●	●	●	●	●	●	●	●	●	●

Insert WSP	Type · Typ	Dimensions (mm) · Abmessungen				CVD Coating / CVD Beschicht.						PVD Coating / PVD Beschicht.				Cermet		Carbide uncoat. / unbe. Hartmetall						
		B	Re	S ₁	D ₁	YBC301	YBC401	YBM251	YBM351	YBD152	YBD252	YBG102	YBG202	YBG205	YBG212	YBG152	YBG252	YNG151	YNG151C	YC30S	YD051	YD101	YD201	
	WPGT050315ZSR	11°	1.5	3.5	7.94				●						○									
	WPGT060415ZSR	11°	1.5	4.2	9.525				●						○									
	WPGT080615ZSR	11°	1.5	6.35	12.85				●					○	○									
	WPGT090725ZSR	11°	2.5	7	15				●						○									

● Ex Stock / ab Lager ○ On demand / auf Anfrage