

Milling · Fräsen

Indexable Milling Tools · Wendeplattenfräser

RC**

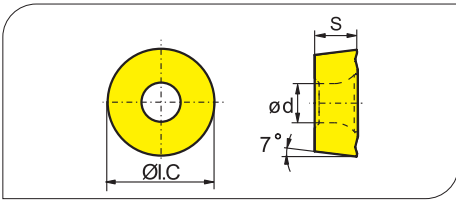

- Ideal Machining Condition / Gute Bearbeitungsbedingungen
- ⊗ Normal Machining Condition / Normale Bearbeitungsbedingungen
- ⊗ Unfavorable Machining Condition / Ungünstige Bearbeitungsbedingungen

Workpiece Material / Werkstoffe	P	M	K	N	S	YBC301	YBC401	YBM251	YBM253	YBM351	YBD152	YBD252	YBG102	YBG202	YBG205	YBG302	YBG152	YBG252	YNG151	YNG151C	YC30S	YD101	YD201
P Steel / Stahl	●	●	●	●	●	●	●	●	●	●	●	●	●	●	●	●	●	●	●	●	●	●	●
M Stainless Steel / Rostfreier Stahl	●	●	●	●	●	●	●	●	●	●	●	●	●	●	●	●	●	●	●	●	●	●	●
K Cast iron / Gusseisen	●	●	●	●	●	●	●	●	●	●	●	●	●	●	●	●	●	●	●	●	●	●	●
N Non-ferrite material / Ne Metalle	●	●	●	●	●	●	●	●	●	●	●	●	●	●	●	●	●	●	●	●	●	●	●
S Heat-resistant steel / Warmfester Stahl	●	●	●	●	●	●	●	●	●	●	●	●	●	●	●	●	●	●	●	●	●	●	●

Insert WSP	Type · Typ	Dimension (mm) / Abmessung			CVD Coating / CVD Beschicht.						PVD Coating / PVD Beschicht.					Cermet		Carbide uncoat. unbe. Hartmetall					
		I.C.	S	d	YBC301	YBC401	YBM251	YBM253	YBM351	YBD152	YBD252	YBG102	YBG202	YBG205	YBG302	YBG152	YBG252	YNG151	YNG151C	YC30S	YD101	YD201	
	RCKT10T3MO-DM	10.0	3.97	4.4	●	●									○								
	RCKT1204MO-DM	12.0	4.76	4.0	●	●	●		●	○			○										
	RCKT1204MO-DR	12.0	4.76	4.0	●	●	●		●														
	RCKT1204MO-ER	12.0	4.76	4.0				○	○														
	RCKT1606MO-DM	16	6.35	5.56	●	●	○									○							
	RCKT1606MO-DR	16	6.35	5.56	●	●			●		●												
	RCKT1606MO-ER	16	6.35	5.56				○	○														
	RCKT2006MO-DM	16	6.35	5.56	●	●																	
	RCKT2006MO-DR	20	6.35	6.55	●	●			●		●												
	RCKT2006MO-ER	20	6.35	6.55				○	○														

RD**

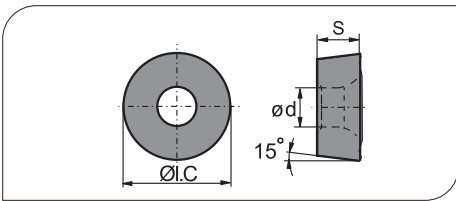

- Ideal Machining Condition / Gute Bearbeitungsbedingungen
- ⊗ Normal Machining Condition / Normale Bearbeitungsbedingungen
- ⊗ Unfavorable Machining Condition / Ungünstige Bearbeitungsbedingungen

Workpiece Material / Werkstoffe	P	M	K	N	S	YBC301	YBC401	YBM251	YBM351	YBD152	YBD252	YBG102	YBG202	YBG205	YBG302	YBG152	YBG252	YNG151	YNG151C	YC30S	YD101	YD201	
P Steel / Stahl	●	●	●	●	●	●	●	●	●	●	●	●	●	●	●	●	●	●	●	●	●	●	●
M Stainless Steel / Rostfreier Stahl	●	●	●	●	●	●	●	●	●	●	●	●	●	●	●	●	●	●	●	●	●	●	●
K Cast iron / Gusseisen	●	●	●	●	●	●	●	●	●	●	●	●	●	●	●	●	●	●	●	●	●	●	●
N Non-ferrite material / Ne Metalle	●	●	●	●	●	●	●	●	●	●	●	●	●	●	●	●	●	●	●	●	●	●	●
S Heat-resistant steel / Warmfester Stahl	●	●	●	●	●	●	●	●	●	●	●	●	●	●	●	●	●	●	●	●	●	●	●

Insert shape Plattenform	Type · Typ	Dimension (mm) / Abmessung			CVD Coating / CVD Beschicht.						PVD Coating / PVD Beschicht.					Cermet		Carbide uncoat. unbe. Hartmetall					
		I.C.	S	d	YBC301	YBC401	YBM251	YBM351	YBD152	YBD252	YBG102	YBG202	YBG205	YBG302	YBG152	YBG252	YNG151	YNG151C	YC30S	YD101	YD201		
	RDKW0702MO	7.0	2.38	2.7				●				●	●										
	RDKW0803MO	8.0	3.18	3.4				●					●										
	RDKW1003MO	10.0	3.18	3.9			●	●				●	●										
	RDKW10T3MO	10.0	3.97	4.4	○			●				●	●										
	RDKW1204MO	12.0	4.76	4.4			○	●				●	●										
	RDKW12T3MO	12.0	3.97	3.9		○	●	●				●	●									○	
	RDKW1604MO	16.0	4.76	5.2				●				●	●										
	RDKW1605MO	16.0	5.56	5.5				●					●		○								
	RDKW2006MO	20.0	6.35	6.5				●		○													

B

Milling Tools · Fräser