

# ARBORS FOR BORING HEADS

**DIN 1806**

**MORSE 5**

## MORSE 5

Dimension					Product Number	Kg.	Coupling Screw
øD	øD1	L	L1	PM			
22	12	112	78	100	<b>305 22 100</b>	1.600	22-68
22	12	142	108	130	<b>305 22 130</b>	1.800	22-68
27	15	65	23	55	<b>305 27 55</b>	1.600	27-610
27	15	113	71	100	<b>305 27 100</b>	1.750	27-610
27	15	143	101	130	<b>305 27 130</b>	1.900	27-610
32	20	70	25	60	<b>305 32 60</b>	1.550	32-810
32	20	143	98	130	<b>305 32 130</b>	2.100	32-810
32	20	173	128	160	<b>305 32 160</b>	2.250	32-810
42	24	83	27	75	<b>305 42 75</b>	1.650	42-1014
42	24	188	86	130	<b>305 42 130</b>	2.250	42-1014
42	24	218	116	160	<b>305 42 160</b>	2.600	42-1014
54	28	172	106	160	<b>305 54 160</b>	3.200	54-1220
54	28	212	146	200	<b>305 54 200</b>	3.950	54-1220
68	36	146	60	140	<b>305 68 140</b>	2.750	68-1624
68	36	212	126	200	<b>305 68 200</b>	4.750	68-1624
68	36	272	186	260	<b>305 68 260</b>	6.400	68-1624
85	50	216	116	200	<b>305 85 200</b>	6.500	85-1630
85	50	276	176	260	<b>305 85 260</b>	8.500	85-1630
85	50	336	236	320	<b>305 85 320</b>	11.150	85-1630
*	100	276	176	260	<b>305 100 260</b>	10.000	100-2035
*	100	336	236	320	<b>305 100 320</b>	13.600	100-2035
*	100	146	56	140	<b>505 160</b>	4.400	M12X40

\* ALSO FOR HEADS Ø200

\* SEE PAGE 38: THE ASSEMBLY SYSTEM FOR LARGE BORING HEADS

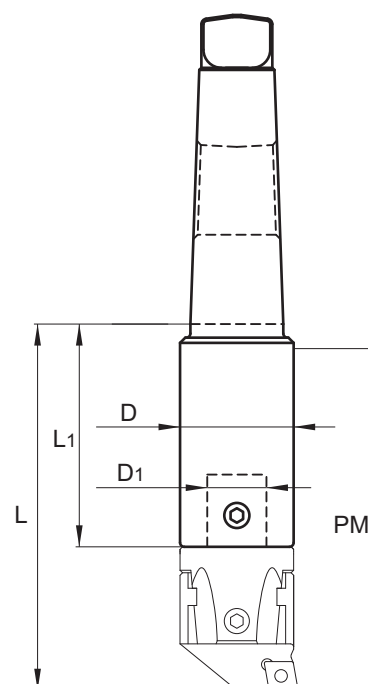

**NOTE:** MORSE 6 ARBORS CAN BE MANUFACTURED AS "SPECIAL" UPON REQUEST