

ROUGH HEADS 75° APPROACH

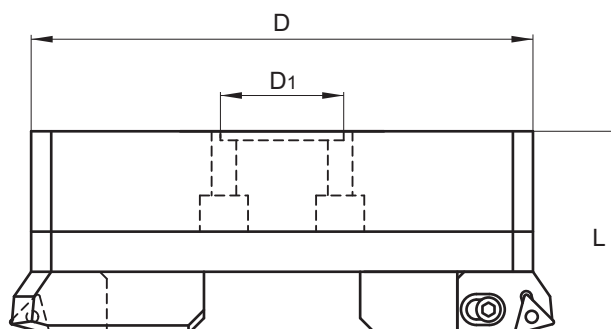

LARGE DIAMETER CARTRIDGE TYPE HEADS SYNCHRONIZED ADJUSTMENT

| Bore Range Min Max | Dimension | | | Product Number | Cartridge * | Clamp Screw | Kg. | Adjustment | | |
|-----------------------|-----------|-----|----|---------------------|-------------|-------------|--------|------------|-----------|-------------|
| | øD | øD1 | L | | | | | Adj. Key | Clamp Key | Locking Key |
| 220 320 | 202 | 60 | 90 | D300 75 300 | 3CT 75 300 | TT 300 | 10.100 | 5 | T15 | 4 |
| 220 320 | 202 | 60 | 90 | D300 75 402 | 3CT 75 402 | TT 402 | 10.100 | 5 | T20 | 4 |
| 220 320 | 202 | 60 | 90 | D300 75 402N | 3CT 75 402N | TT 402N | 10.100 | 5 | 2.5 | 4 |
| 290 400 | 272 | 60 | 90 | D400 75 300 | 3CT 75 300 | TT 300 | 13.750 | 5 | T15 | 4 |
| 290 400 | 272 | 60 | 90 | D400 75 402 | 3CT 75 402 | TT 402 | 13.750 | 5 | T20 | 4 |
| 290 400 | 272 | 60 | 90 | D400 75 402N | 3CT 75 402N | TT 402N | 13.750 | 5 | 2.5 | 4 |
| 370 500 | 352 | 60 | 90 | D500 75 300 | 3CT 75 300 | TT 300 | 16.900 | 5 | T15 | 4 |
| 370 500 | 352 | 60 | 90 | D500 75 402 | 3CT 75 402 | TT 402 | 16.900 | 5 | T20 | 4 |
| 370 500 | 352 | 60 | 90 | D500 75 402N | 3CT 75 402N | TT 402N | 16.900 | 5 | 2.5 | 4 |

* FULL CARTRIDGE INFORMATION (INCLUDING INSERT SIZE) IN PAGE 19