

## JACK SET FOR GRANITE SURFACE PLATES

- 5 jacks per set
- Adjustable height
- For large granite surface plates:  
2000x1000x220mm  
(code **6900-0201** and **6900-1201**)  
2000x1500x250mm  
(code **6900-0202** and **6900-1202**)

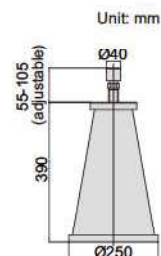

Code

**6903-B**

**6903-B**

## MAGNETIC RECTANGULAR BLOCKS

HARDENED  
SURFACES

HIGH  
PRECISION

STRONG  
MAGNETIC FORCE

- For grinding, light milling, drilling and inspection of round and square jobs
- Hardened, high accuracy, strong magnetic force
- Working surfaces are hardened to HRC58-62
- Magnetic force on top, bottom and back sides
- Supplied in matched pair

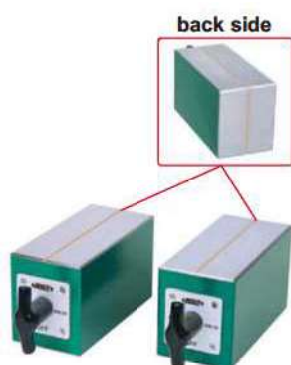

**6898-150**

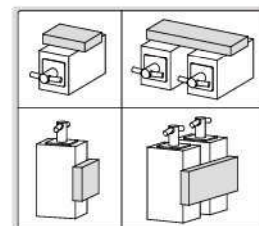
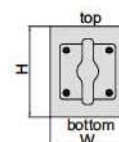

Code	Size (LxWxH)	Magnetic force	Parallelism of top to bottom side	Squareness of top and bottom to back side	Height difference of a matched pair
<b>6898-100</b>	100x70x70mm	100kgf	5µm	5µm	5µm
<b>6898-150</b>	150x70x85mm	125kgf	5µm	5µm	5µm

## V-BLOCK SETS

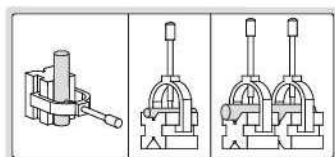

- Hold cylindrical workpieces for inspection and machining
- Two V-blocks per set
- Made of alloy steel
- Hardened to HRC60±2
- V groove on the top for large shafts
- V groove on the bottom for small shafts (except **6896-10**)



**6896-10**



**6896-11**

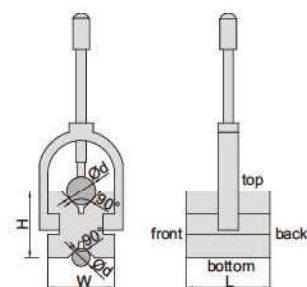

Code	Size (LxWxH)	Range of shafts (Ød)	Parallelism of both V grooves to top and bottom sides	Squareness of both V grooves to front and back sides	Height difference of a matched pair
<b>6896-10</b>	25x20x20mm	3-20mm	3µm	3µm	3µm
<b>6896-11</b>	50x40x40mm	5-30mm	5µm	5µm	5µm
<b>6896-12</b>	80x63x63mm	7-63mm	5µm	5µm	5µm
<b>6896-13</b>	100x80x80mm	7-80mm	5µm	5µm	5µm
<b>6896-14</b>	70x140x140mm	9-140mm	5µm	5µm	5µm