



DATA
OUTPUT

DIGITAL INDICATORS WITH LIFTING LEVER

- Reading in digital and analog
- Display can be rotated by 320°
- Button function: tolerance Go and No-Go display, data preset, measuring direction change, max./min./TIR measurement, inch/metric conversion, absolute/incremental measurement
- CR2032 battery, automatic power off
- Data output
- Optional accessory: data output cable (code 7306-40, 7302-SPC3A, 7305-SPC1A), backs (page 104~105), contact points (page 102~103)



2109-10

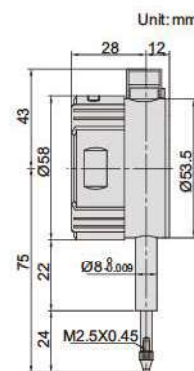

Code	Range	Resolution	Accuracy	Hysteresis	Remark
2109-10*	10mm/0.4"	0.01mm/0.0005"	20μm	10μm	flat back
2109-101*	10mm/0.4"	0.001mm/0.00005"	5μm	2μm	flat back

* Supplied with manufacturer inspection certificate traceable to NIST USA



2118-10

BACK PLUNGER TYPE DIGITAL INDICATORS



DATA
OUTPUT

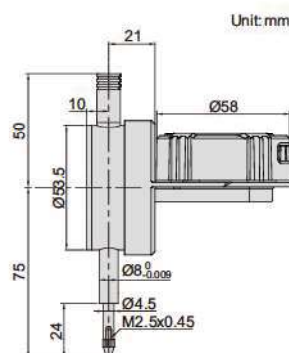

- Display can rotate 320°, and display direction is changeable
- Reading in digital and analog
- Button function: tolerance Go and No-Go display, data preset, measuring direction change, max./min./TIR measurement, inch/metric conversion, absolute/incremental measurement
- CR2032 battery, automatic power off
- Data output
- Optional accessory: data output cable (code 7306-40, 7302-SPC3A, 7305-SPC1A), backs (page 104~105), contact points (page 102~103)

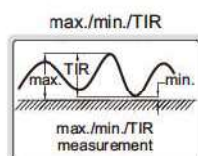

spindle lift knob
is included



display can rotate 320°



display direction is changeable

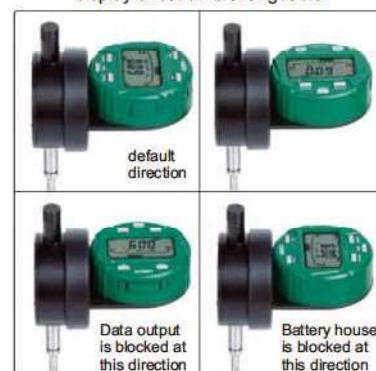

Code	Range	Resolution	Accuracy	Hysteresis	Remark
2118-10 *	12.7mm/0.5"	0.01mm/0.0005"	20μm	10μm	flat back
2118-101 *	12.7mm/0.5"	0.001mm/0.00005"	5μm	2μm	flat back

Remark: To change above direction, 4 fixing screws on the back of display need to be removed first.

* Supplied with manufacturer inspection certificate traceable to NIST USA