

**3 MORSE IN UNA
VISES IN ONE**



Art. 855

Modulo base universale / Universal vise body module

Tipo (grandezza) morsa / Vise (type) size	1 25 kN		2 25 kN				3 30 kN		
kN									
Apertura massima fra le slitte / Maximum opening between slides	A	56	68	96	116	136	156	136	136
	C	70		90				100	
	D	200 + 32	300 + 32	300	400	500	600	400	500
	E	220 + 32	230 + 32	320	420	520	620	425	525
	G	75		95				125	
	R	74		94				124	
	S	69		89				99	
	T	72	116	102	142	182	222	132	182
	Y	245 + 32	345 + 32	360	460	560	660	470	570
	X	357 + 32	451 + 32	537	637	737	837	637	737
	kg	7	10	18	25	32	39	40	45

Cod. 5.85.51200 5.85.51300 5.85.52300 5.85.52400 5.85.52500 5.85.52600 5.85.53400 5.85.53500

Art. 855D

(Art. 855 + 802) Morsa + moltiplicatore di coppia / Vise + torque multiplier

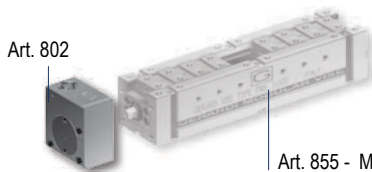

Art. 855 - Modulo base universale / Universal vise body module

Cod. 5.85.5D120 5.85.5D130 5.85.5D230 5.85.5D240 5.85.5D250 5.85.5D260 5.85.5D340 5.85.5D350

Art. 855E

(Art. 855 + 890) Morsa + motore idraulico / Vise + hydraulic motor

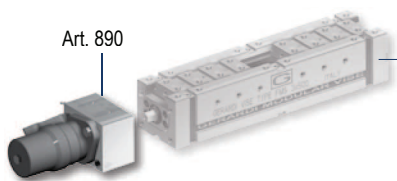

Art. 855 - Modulo base universale / Universal vise body module

Cod. 5.85.5E120 5.85.5E130 5.85.5E230 5.85.5E240 5.85.5E250 5.85.5E260 5.85.5E340 5.85.5E350

Art. 855F

(Art. 855 + 890 + 266B) Morsa + motore idraulico + centralina / Vise + hydraulic motor + power unit

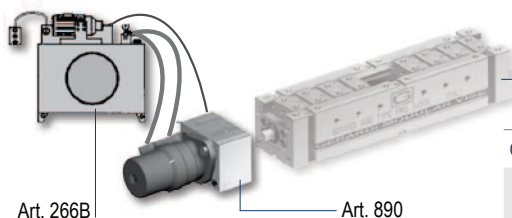

Art. 855 - Modulo base universale / Universal vise body module

Cod. 5.85.5F120 5.85.5F130 5.85.5F230 5.85.5F240 5.85.5F250 5.85.5F260 5.85.5F340 5.85.5F350

Art. 855

Modulo base universale / Universal vise body module

Dotazione standard:

- 2 arresti laterali Art. 370
- 1 coppia di tasselli di posizionamento precisi Art. 297
- 1 chiave a pipa Art. 375
- 1 piastrina di collegamento Art.801S

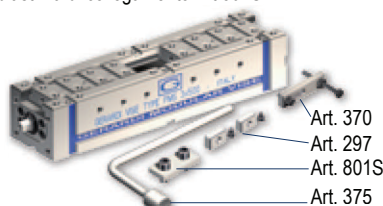

Standard equipment:

- 2 workstops Art. 370
- 1 pair of precision positioning key-nuts Art. 297
- 1 box wrench Art. 375
- 1 connecting plate Art.801S

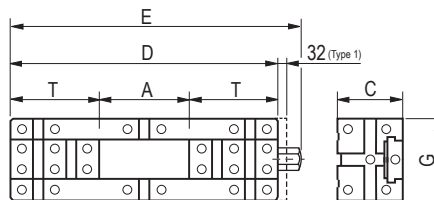

Art. 855

Serraggio meccanico
Universal vise body module

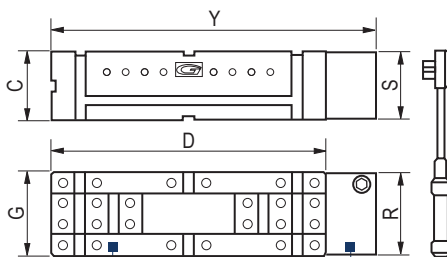

Art. 855D

Meccanica con moltiplicatore di coppia
e chiave dinamometrica
Mechanical with torque multiplier
and torque wrench

Art. 855

Art. 802

Art. 375

3 30 kN			4 30 kN				5 32 kN			6 32 kN		
136	136	136	188	168	148	128	152	216	252	316	280	244
	100			120				140			160	
600	700	800	500	600	700	800	600	700	800	800	900	1000
625	725	825	525	625	725	825	625	725	825	825	925	1025
	125			145				170			190	
	124			144				169			189	
	99			119				139			159	
232	282	332	156	216	276	336	174	242	274	242	310	378
670	770	870	570	670	770	870	-	-	-	-	-	-
837	937	1037	737	837	937	1037	837	937	1037	1037	1137	1237
50	55	60	66	72	80	88	115	125	135	170	190	210
5.85.53600	5.85.53700	5.85.53800	5.85.54500	5.85.54600	5.85.54700	5.85.54800	5.85.55600	5.85.55700	5.85.55800	5.85.56800	5.85.56900	5.85.56100



Art. 855D (Art. 855 + 802) Morsa + moltiplicatore di coppia / Vise + torque multiplier

5.85.5D360	5.85.5D370	5.85.5D380	5.85.5D450	5.85.5D460	5.85.5D470	5.85.5D480	5.85.5D560	5.85.5D570	5.85.5D580	5.85.5D680	5.85.5D690	5.85.5D610
------------	------------	------------	------------	------------	------------	------------	------------	------------	------------	------------	------------	------------

Art. 855E

(Art. 855 + 890)
Morsa + motore idraulico
Vise + hydraulic motor

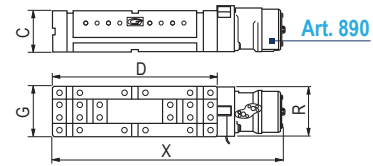

Meccanica con predisposizione elettroidraulica completa di motore, piastra, boccia e fincorsa
Mechanical with prepared hydraulic connection complete with motor plate, bushing and proximity switch

5.85.5E360	5.85.5E370	5.85.5E380	5.85.5E450	5.85.5E460	5.85.5E470	5.85.5E480	5.85.5E560	5.85.5E570	5.85.5E580	5.85.5E680	5.85.5E690	5.85.5E610
------------	------------	------------	------------	------------	------------	------------	------------	------------	------------	------------	------------	------------

Art. 855F

(Art. 855 + 890 + 266B)
Morsa + motore idraulico + centralina
Vise + hydraulic motor + power unit

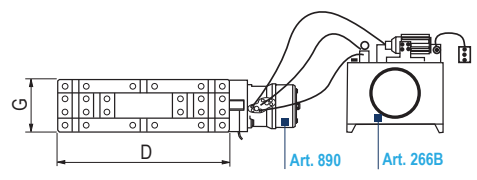

Meccanica elettroidraulica completa di centralina idraulica e apparecchiatura elettrica con pulsantiera
Mechanical with electrohydraulic power-pack ready to work

5.85.5F360	5.85.5F370	5.85.5F380	5.85.5F450	5.85.5F460	5.85.5F470	5.85.5F480	5.85.5F560	5.85.5F570	5.85.5F580	5.85.5F680	5.85.5F690	5.85.5F610
------------	------------	------------	------------	------------	------------	------------	------------	------------	------------	------------	------------	------------

Art. 855

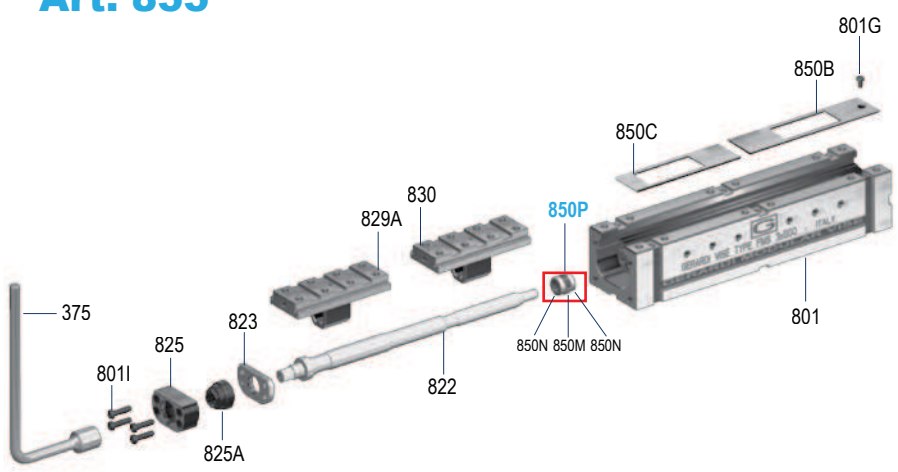

Art.	Pag.	Art.	Pag.
375	4.27	850B	5.54
801	5.40	850C	5.54
801G	5.54	-	-
801I	5.54	-	-
805C	5.49	-	-
822	5.46	-	-
823	5.52	-	-
825	5.52	-	-
825A	5.54	-	-
829A	5.44	-	-
830	5.44	-	-