

## Portapezzi in ghisa con Zero Point / Cast iron tombstones with Zero Point

**GERARDI SpA** ha sviluppato una gamma di portapezzi in fusioni **monoblocco di ghisa G30** e recentemente anche di **alluminio speciale ad alta resistenza**. Forme di: Cubi, Spalle, Squadre, Piastre, Mensole e speciali a richiesta. Come **lavorazioni e finiture** vengono proposte le seguenti:

The **Gerardi Modular Workholding System** is a range of modular tombstones and sub-plates. They are manufactured in the most different shapes and finishing, anyway always provided in one **solid cast iron cast G30** (see pages 8.3 and 8.4). Recently also in **high resistance aluminum**. The shapes available are: **Cubes, 2 sides tombstones, Angles, Plates and subplates, Shelves and specials on specific request**. As **finishing** following are available:



### Art. 53A

Fusioni monoblocco.  
Sgrossati di fresa  
One solid cast iron.  
Rough milled



### Art. 53B

Fusioni sgrossate con  
sovrametallo e base finita  
Rough milled casting with  
overall material and  
base finished

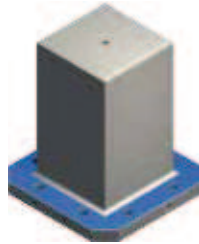

### Art. 53C

Completamente finiti.  
Tolleranza entro  $\pm 0,02$  mm  
Completely finished with  
tol of  $\pm 0,02$  mm

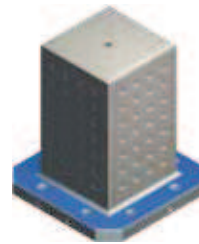

### Art. 53E

Con reticolo di fori calibrati  
e filetti interni integrali  
Grid tombstone with calibrated  
holes and solid threads

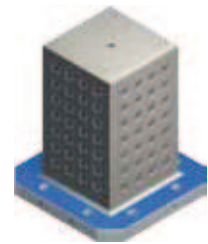

### Art. 53F

Con reticolo di bussole  
temprate 100Cr6 e filetti  
riportati in acciaio inox  
Grid tombstone with  
hardened bushings 100Cr6  
and inox steel helicoils

Il sistema Zero Point Gerardi è predisposto per essere applicato all' ampia gamma di portapezzi, ampliando così la modularità del sistema Gerardi. In particolare:

- Zero Point Idraulico Art.663, montabile direttamente senza alcuna modifica. (vedi pag. 9.6)
- Zero Point Pneumatico Art.665, montabile tramite l'utilizzo della flangia Art.665F

The Gerardi Zero Point system has been designed to be used with the wide range of tombstones increasing in this way the modularity of the Gerardi system. In particular:

- Hydraulic Zero Point Art.663, can be assembled directly without any change (see pag. 9.6)
- Pneumatic Zero Point Art.665, can be assembled through the Art.665F flange

### Art. 665

Montaggio incassato  
Built-in mounting



### Art. 665F

Flangia - Flange



## Art. 665X

Montaggio verticale incassato con flangia  
Built-in vertical mounting with flange



Kg	5,8
Cod.	8.66.5X200

