

Tipo (grandezza) morsa / Vise (type) size	1	2	3	4	5	6
<b>Art. 810D</b> Ganascia mobile con gradino 3x5 zigrinata da un lato Movable jaw with 3x5 step on side serrated	Cod. 5.81.0D100	5.81.0D200	5.81.0D300	5.81.0D400	5.81.0D500	5.81.0D600
<b>Art. 810E</b> Ganascia mobile con gradino 3x5 liscia Movable jaw with 3x5 step smooth	Cod. 5.81.0E100	5.81.0E200	5.81.0E300	5.81.0E400	5.81.0E500	5.81.0E600
<b>Art. 810J</b> Ganascia mobile prismatica per tondi liscia Prismatic movable jaw for round parts smooth	Cod. 5.81.0J100	5.81.0J200	5.81.0J300	5.81.0J400	5.81.0J500	5.81.0J600
<b>Art. 810K</b> Ganascia mobile prismatica per tondi zigrinata Prismatic movable jaw for round parts serrated	Cod. 5.81.0K100	5.81.0K200	5.81.0K300	5.81.0K400	5.81.0K500	5.81.0K600
<b>Art. 810L</b> Ganascia mobile con gradino Step movable jaw	Cod. 5.81.0L100	5.81.0L200	5.81.0L300	5.81.0L400	5.81.0L500	5.81.0L600
<b>Art. 810M</b> Ganascia mobile con gradino zigrinata da un lato Step movable jaw one side serrated	Cod. 5.81.0M100	5.81.0M200	5.81.0M300	5.81.0M400	5.81.0M500	5.81.0M600
<b>Art. 810O</b> Ganascia mobile con gradino piccolo e grande Movable jaw with small and large step	Cod. 5.81.0O100	5.81.0O200	5.81.0O300	5.81.0O400	5.81.0O500	5.81.0O600
<b>Art. 810P</b> Ganascia mobile con gradino piccolo e grande zigrin. da un lato Movable jaw with small and large step one side serrated	Cod. 5.81.0P100	5.81.0P200	5.81.0P300	5.81.0P400	5.81.0P500	5.81.0P600
<b>Art. 810R</b> Ganascia mobile in alluminio Movable jaw aluminium	Cod. 5.81.0R100	5.81.0R200	5.81.0R300	5.81.0R400	5.81.0R500	5.81.0R600
<b>Art. 810T</b> Ganascia mobile <b>GRIP</b> per forti serraggi <b>GRIP</b> movable jaw for strongest clamping	Cod. 5.81.0T100	5.81.0T200	5.81.0T300	5.81.0T400	5.81.0T500	5.81.0T600
<b>Art. 810V</b> Ganascia mobile con segmenti oscillanti Movable jaw with floating inserts	Cod. 5.81.0V100	5.81.0V200	5.81.0V300	5.81.0V400	5.81.0V500	5.81.0V600

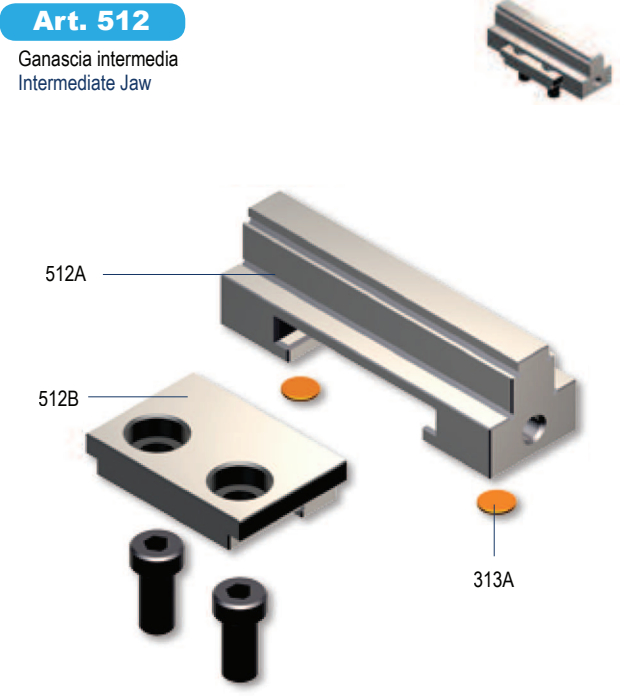

Tipo - Type	1	2	3	4	5	6
Cod. 5.51.21000	5.51.22000	5.51.23000	5.51.24000	5.51.25000	5.51.26000	

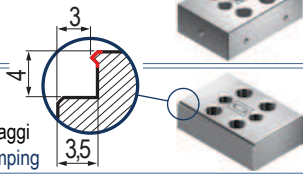
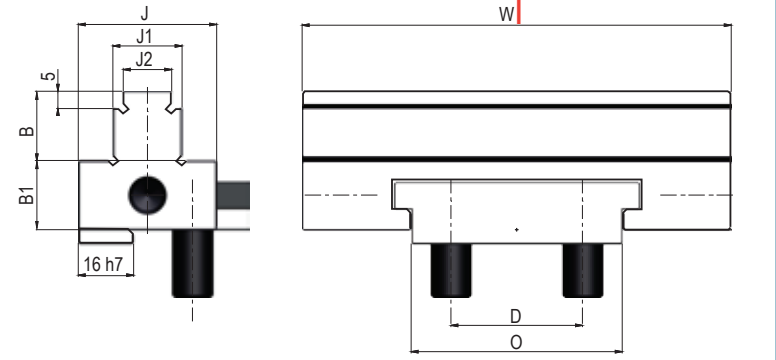

Tipo - Type	1	2	3	4	5	6
W	74	94	124	144	169	189
J	25	35	40	40	50	50
J1	15	15	20	20	30	30
J2	9	9	14	14	19	19
B / B1	12,5	15	20	25	30	30
D	20	25	38	44	44	54
O	34	40	60	70	81	93

Vedi esempio applicativo - See application example: Pag. 5.13