

DISPOSITIVI MECCANICI / MECHANICAL BLOCKING DEVICES

Tipo (grandezza) morse / Vise (type) size

1	2	3	4	5	6
---	---	---	---	---	---

Art. 258

 Gruppo di serraggio meccanico completo
 senza accessori

 Mechanical clamping device complete
 No accessories

kg	0,4	1	1,9	2,9	5,3	7,8
Cod.	2.25.81000	2.25.82000	2.25.83000	2.25.84000	2.25.85000	2.25.86000

 Per le forze di serraggio vedi pag. 4.00
 For clamping force see page 4.00

RICAMBI / SPARE PARTS

Art. 360

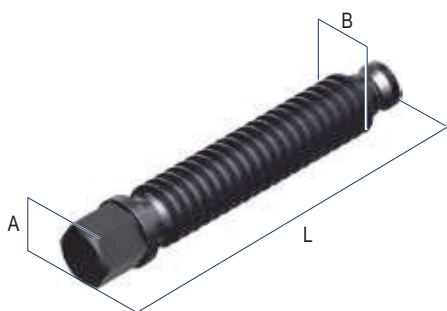
 Vite di spinta. Normale
 Clamping bolt. Normal

A	16	19	22	30
B	M12	18 x 4	24 x 5	30 x 5
L	100	130	150	190
Cod.	1.90.10144	1.90.20184	1.90.30.245	1.90.50366

Art. 355

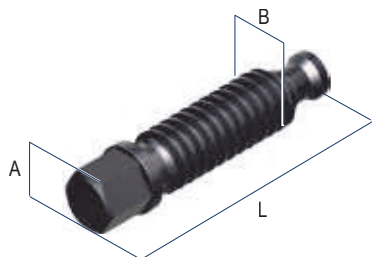
 Vite di spinta. Ridotta
 Clamping bolt. Short

A	16	19	22	36
B	M12	18 x 4	24 x 5	30 x 5
L	90	100	115	150
Cod.	1.90.14144	1.90.24184	1.90.34245	1.90.54366

Art. 356

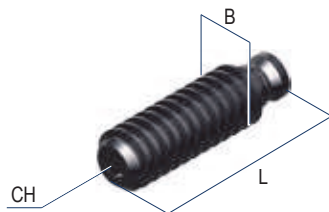
 Vite di spinta. Super ridotta
 Clamping bolt. Super short

CH	-	8	10	-
B	M12	18 x 4	24 x 5	30 x 5
L	53	73	81	113
Cod.	1.35.61000	1.35.62000	1.35.60003	1.35.60005

Art. 282

 Supporto di serraggio meccanico
 Mechanical clamping device support

Cod.	2.28.21000	2.28.22000	2.28.23000	2.28.24000	2.28.25000	2.28.26000

Art. 410

 Grano
 Setscrew

	0.06.20810	0.06.21012	0.06.21216	0.06.21620	0.06.21630	0.06.31360
Cod.	M8 x 20	M10 x 25	M12 x 30	M12 x 40	M20 x 50	M20 x 50
	CH. 3	CH. 5	CH. 6	CH. 6	CH. 10	CH. 10

Art. 361

 Sfera
 Ball

Cod.	1.36.11001	1.36.12002	1.36.13003	1.36.14004	1.36.15005	1.36.16006
	9/16"	3/4"	7/8"	7/8"	1 1/8"	1 1/8"