

## Ricambi per ganasce con **PIASTRE PIANE** / Spares for **STRAIGHT STD** jaws

Tipo (grandezza) morsa / Vise (type) size	1	2	3	4	5	6
---	---	---	---	---	---	---

**PIASTRE PIANE TEMPRATE, RIGATE O QUADRETTATE**

**HARDENED GROOVED OR SERRATED STRAIGHT JAW PLATES**

Dotazione normale delle ganasce e delle morse complete  
Standard equipment on complete jaws and vises

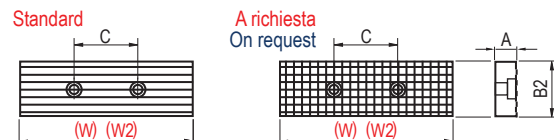

**Art. 242 (W) Art. 242S (W)**

Per ganasca fissa e mobile - Art. 140, 143, 146 - Larghezza normale (W)  
For fixed and movable jaw - Art. 140, 143, 146 - Normal width (W)

**Art. 243 (W2) Art. 243S (W2)**

Per ganasca fissa e mobile - Art. 141, 144, 147 - Larghezza ridotta (W2)  
For fixed and movable jaw - Art. 141, 144, 147 - Narrow width (W2)

cad / each

Per qualsiasi piastra ganasca speciale, raddoppiare il prezzo / For special tailor made jaw plate double the price

	100	125	150	175	200	300
W	100	125	150	175	200	300
W2	74	94	124	144	169	194
A	12	12	13	13	18	18
B2	24,5	32	40	43	48	56
C	25	32	50	50	75	90

Cod. Art. 242	1.65.16000	1.65.26000	1.65.36000	1.65.46000	1.65.56000	1.65.66000
Cod. Art. 242S	4.24.2S100	4.24.2S200	4.24.2S300	4.24.2S400	4.24.2S500	4.24.2S600
Cod. Art. 243	1.65.17000	1.65.27000	1.65.37000	1.65.47000	1.65.57000	1.65.67000
Cod. Art. 243S	4.24.3S100	4.24.3S200	4.24.3S300	4.24.3S400	4.24.3S500	4.24.3S600

**PIASTRE PIANE LISCE TEMPRATE**

Fornibili a richiesta su ganasce e morse senza variazione di prezzo

**HARDENED SMOOTH STRAIGHT JAW PLATES**

Available on request for complete jaws and vises without price change

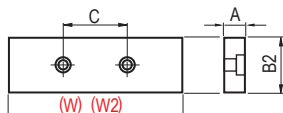

**Art. 244 (W)**

Per ganasca fissa e mobile - Art. 140, 143, 146 - Larghezza normale (W)  
For fixed and movable jaw - Art. 140, 143, 146 - Normal width (W)

**Art. 245 (W2)**

Per ganasca fissa e mobile - Art. 141, 144, 147 - Larghezza ridotta (W2)  
For fixed and movable jaw - Art. 141, 144, 147 - Narrow width (W2)

Cod. Art. 244	4.24.41000	4.24.42000	4.24.43000	4.24.44000	4.24.45000	4.24.46000
---------------	------------	------------	------------	------------	------------	------------

Cod. Art. 245	4.24.51000	4.24.52000	4.24.53000	4.24.54000	4.24.55000	4.24.56000
---------------	------------	------------	------------	------------	------------	------------

**PIASTRE PIANE IN ACCIAIO LAVORABILE (DOLCE)**

Fornibili a richiesta su ganasce e morse senza variazione di prezzo

**MACHINEABLE STEEL STRAIGHT JAW PLATES (SOFT HRC)**

Available on request for complete jaws and vises without price change

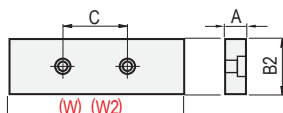

**Art. 246 (W)**

Per ganasca fissa e mobile - Art. 140, 143, 146 - Larghezza normale (W)  
For fixed and movable jaw - Art. 140, 143, 146 - Normal width (W)

**Art. 247 (W2)**

Per ganasca fissa e mobile - Art. 141, 144, 147 - Larghezza ridotta (W2)  
For fixed and movable jaw - Art. 141, 144, 147 - Narrow width (W2)

Cod. Art. 246	1.65.16200	1.65.26200	1.65.36200	1.65.46200	1.65.56200	1.65.66200
---------------	------------	------------	------------	------------	------------	------------

Cod. Art. 247	1.65.17200	1.65.27200	1.65.37200	1.65.47200	1.65.57200	1.65.67200
---------------	------------	------------	------------	------------	------------	------------

**PIASTRE PIANE TEMPRATE GRIP**

Fornibili a richiesta su ganasce e morse senza variazione di prezzo

**HARDENED STRAIGHT JAW PLATES GRIP**

Available on request for complete jaws and vises without price change

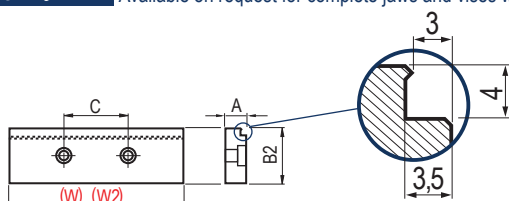

**PIASTRE GANASCE "GRIP" JAW PLATES**

< Superficie Surface > Pressione Pressure

**Art. 246T (W)**

Per ganasca fissa e mobile - Art. 140, 143, 146 - Larghezza normale (W)  
For fixed and movable jaw - Art. 140, 143, 146 - Normal width (W)

**Art. 247T (W2)**

Per ganasca fissa e mobile - Art. 141, 144, 147 - Larghezza ridotta (W2)  
For fixed and movable jaw - Art. 141, 144, 147 - Narrow width (W2)

Cod. Art. 246T	4.24.6T100	4.24.6T200	4.24.6T300	4.24.6T400	4.24.6T500	4.24.6T600
----------------	------------	------------	------------	------------	------------	------------

Cod. Art. 247T	4.24.7T100	4.24.7T200	4.24.7T300	4.24.7T400	4.24.7T500	4.24.7T600
----------------	------------	------------	------------	------------	------------	------------