

Tiranti / Pull-stud

Il fissaggio ed il posizionamento delle attrezzature, o del particolare da lavorare, si effettua tramite i tiranti **Art.10** e **Art.11**
 The clamping and the positioning of the fixtures, or directly the workpiece, is done through pull-studs **Art.10** and **Art.11**

PERNO TIRANTE DI CENTRAGGIO (2 Assi)	PERNO TIRANTE (1 Asse)
PULL-STUD FOR CENTERING (2 Axis)	CLAMPING PULL-STUD (1 Axis)

Il tipo "A" si utilizza per il centraggio e il bloccaggio il tipo "B" solo per il bloccaggio - Type "A" is used for both centering and clamping, type "B" is only for clamping

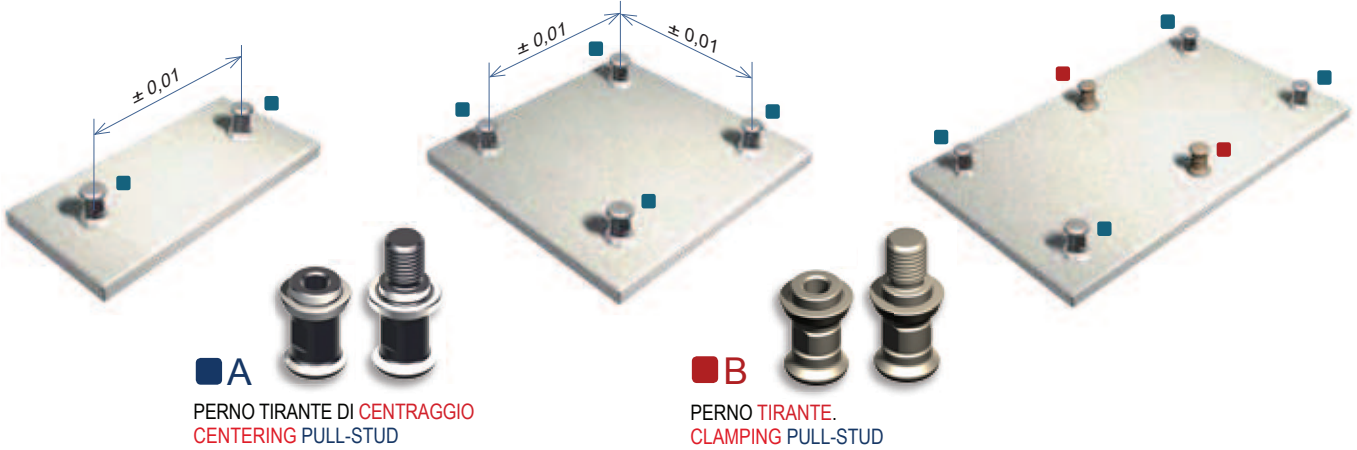

TIPO 1 - TYPE 1

Art. 10A Tipo 1 - Type 1

Perno tirante di **centraggio**. Filetto femmina
 Centering pull-stud. Female thread

Alloggiamento tirante
 Pull-stud seat

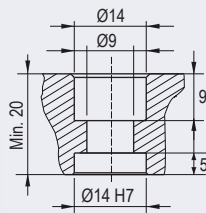
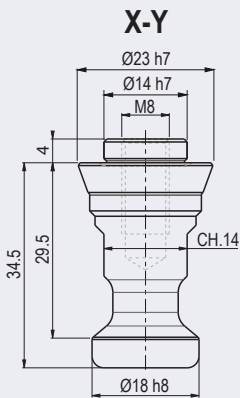

Cod. 9.10.A1000

Art. 10B Tipo 1 - Type 1

Perno **tirante**. Filetto femmina
 Clamping pull-stud. Female thread

Alloggiamento tirante
 Pull-stud seat

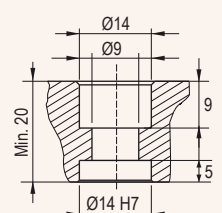
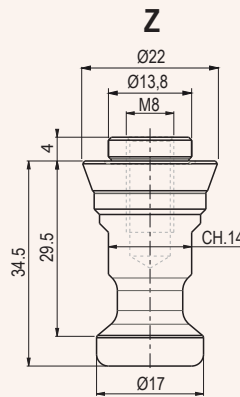

Cod. 9.10.B1000

Art. 11A Tipo 1 - Type 1

Perno tirante di **centraggio**. Filetto maschio
 Centering pull-stud. Male thread

Alloggiamento tirante
 Pull-stud seat

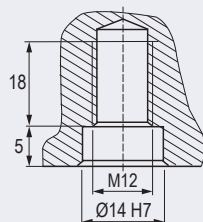
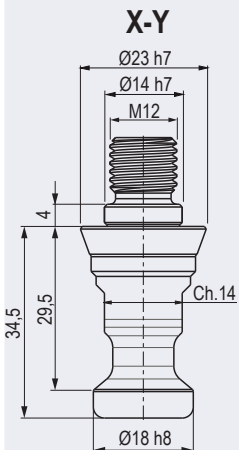

Cod. 9.11.A1000

Art. 11B Tipo 1 - Type 1

Perno **tirante**. Filetto maschio
 Clamping pull-stud. Male thread

Alloggiamento tirante
 Pull-stud seat

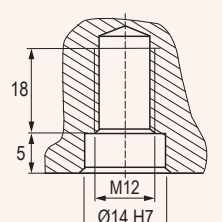
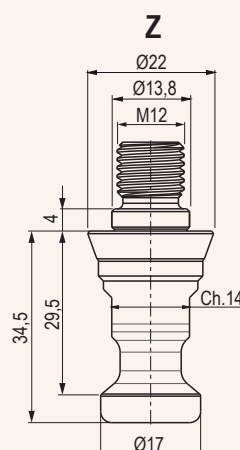

Cod. 9.11.B1000

Tiranti / Pull-stud

ZERO POINT SINGOLO TIPO 2 - SINGLE ZERO POINT TYPE 2

Art. 10S Tipo 2 - Type 2

Perno tirante di **centraggio** per Zero Point **singolo**. Filetto femmina
Centering pull-stud for **single** Zero Point. Female thread



Art. 11S Tipo 2 - Type 2

Perno tirante di **centraggio** per Zero Point **singolo**. Filetto maschio
Centering pull-stud for **single** Zero Point. Male thread

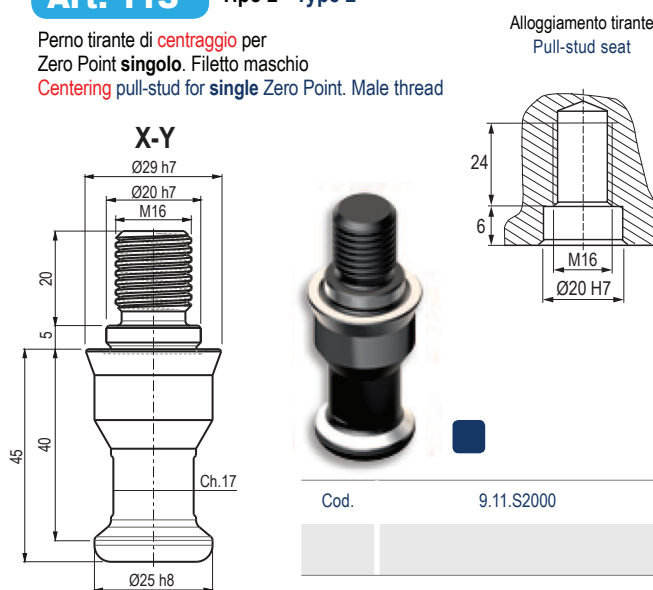

TIPO 2 - TYPE 2

Art. 10A Tipo 2 - Type 2

Perno tirante di **centraggio**. Filetto femmina
Centering pull-stud. Female thread

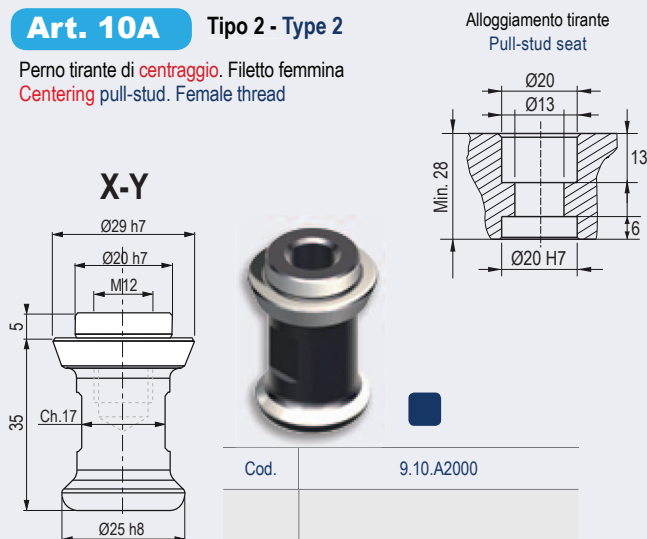

Art. 10B Tipo 2 - Type 2

Perno **tirante**. Filetto femmina
Clamping pull-stud. Female thread

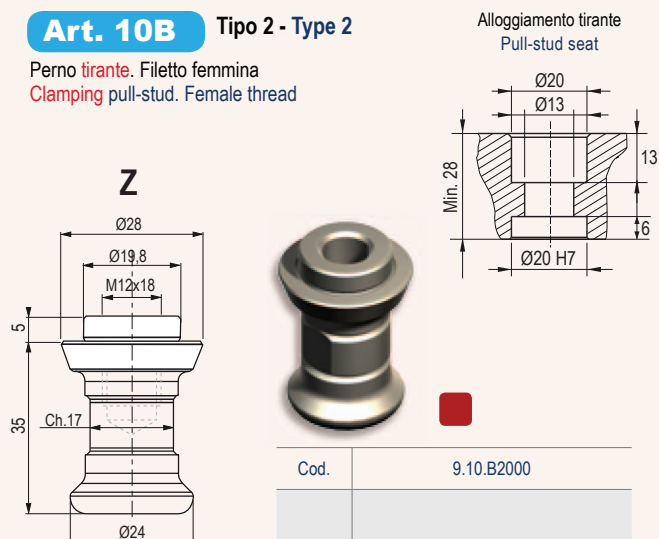

Art. 11A Tipo 2 - Type 2

Perno tirante di **centraggio**. Filetto maschio
Centering pull-stud. Male thread

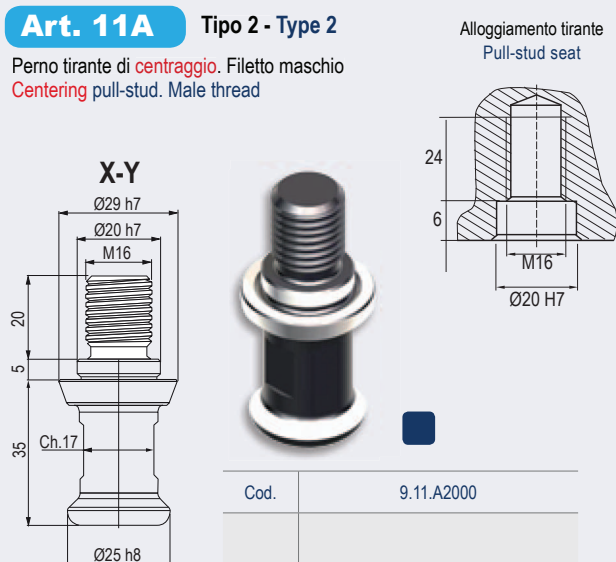

Art. 11B Tipo 2 - Type 2

Perno **tirante**. Filetto maschio
Clamping pull-stud. Male thread

